

COXO[®]
Professional Dental Manufacturer



CE 0482

CONTRA ANGLE **Operation Manual**

MODEL: CX235



**Please read this operation Manual
carefully and file for future reference.**

<https://www.alandental.com>

Preface

Thanks for purchasing our dental Contra angle !

In order to fully exert the function of this equipment, safely and effectively use this equipment, please read this instruction carefully before using , and please keep this manual well for reference anytime.

Under regulations' request, we have been committed to the optimization of our product, this may cause some parts of change, when you find the product appears some difference from description in the manual, please contact the dealers or our after-sales center for details .

Technical specifications

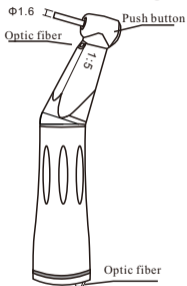
- Protection of liquids-normal liquids – protected equipment
- Temperatures range: -40°C --- $+135^{\circ}\text{C}$
- Relative humidity:10% to 80%,non-condensing
- Noise: $\leq 70\text{dB}$

WARNING

- Please read this operation manual carefully before use and file it for future reference .
- This product is specialized for stomatology treatment abnormal, don't use it in other ways.
- This product is only for doctors.
- Every time you use it, please check first. If find anything unnormal, stop using immediately, and contact your supplier or our after-sales center for details.
- Before operating low speed handpiece, pull contra angle handpiece with hand to make sure handpiece connect firmly and safely.
- Head can not running without insert bur, otherwise head or motor would be damaged.
- Ensure working pressure before running, Air pressure for four hole air motor is 0.3Mpa, for two hole air motor is 0.25Mpa.
- Don't immerse handpiece in any chemical solvent or solution or by dry-heat disinfection. Sterilization by autoclave at $(135\pm 2)^{\circ}\text{C}$ & 0.22MPa is suggested.

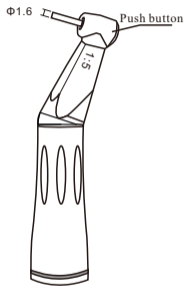
Product Composition

Inner channel contra angle speed increase 1:5



(CX235C7-5)

Optic fiber Inner channel push button contra angle



(CX235C7-6)

Inner channel push button contra angle

Technical parameters:

- Inner channel contra angle low speed handpiece ;
- Burs applicable: for CA burs $\Phi 1.6$;
- Max. speed of contra angle: 200,000rpm
- Speed: speed up to 5times
- Chuck speed: push button
- Spray: 4 way spray

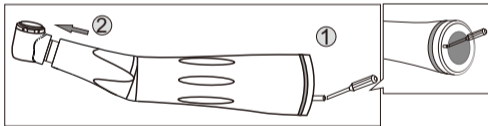
Cartridge Replacement

Fig. 1.1

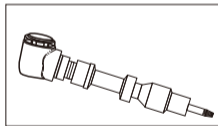


Fig. 1.2

1. Use a screwdriver to make the screw out from the tail of the contra angle and pull out small head from outside, as shown in figure 1-1.

Technical parameters:

- Inner channel contra angle low speed handpiece ;
- Burs applicable: for CA burs $\Phi 1.6$;
- Max. speed of contra angle: 200,000rpm
- Speed: speed up to 5times
- Chuck speed: push button
- Spray: 4 way spray

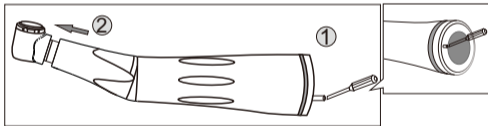
Cartridge Replacement

Fig. 1.1

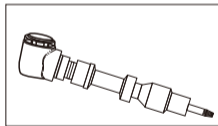


Fig. 1.2

1. Use a screwdriver to make the screw out from the tail of the contra angle and pull out small head from outside, as shown in figure 1-1.

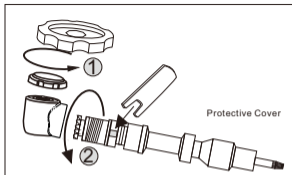


Fig. 1.3

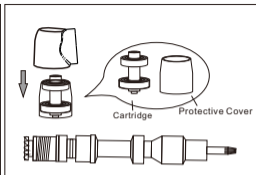


Fig. 1.4

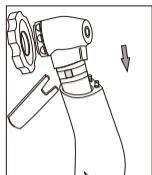


Fig. 1.5

2. Use the unloading tool to open the rear cover, and make shaft out from small head .as shown in figure 1-3.
3. Take the cartridge and cartridge set out ,replace the new cartridge. as shown in figure 1-4.
4. After Replacing the new cartridge ,use the loading tool to tighten the back cover and shaft , You must aim for insert of the fuselage, as shown in figure 1-4, tighten screw of the tail part

Contra angle and motor connections

1. Straightly insert the motor into the connection of contra angle, until you hear a "cracking" sound can be.
2. Hold the bending machine and pull out the motor, it will be separated [fig.3.2].
3. Alignment the groove, contra angle can insert into the air motor [fig.3.3].

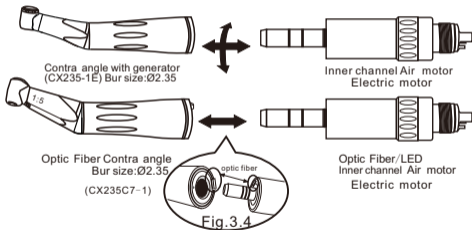


Fig. 3.1

Fig. 3.2

Fig. 3.3

Lubrication

After daily use, spray lubricant for 1 to 2 seconds by inserting lubricant nozzle all the way into drive air tube.

If work heavily, lubrication should be implemented at noon and afternoon's after using everyday.

Lubricate the head, gear and inside. [Fig. 16]
When lubricate the head, please open the latch chuck.

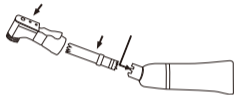


Fig. 16.3

- *Dismount contra handpiece from motor.
- *Install E spray nozzle on the lubricant.
- *Insert E spray nozzle on the back of contra handpiece to spray 2-3 seconds till the lubricant through out of head, Stop until clean lubrication comes out.
- *Keep contra handpiece standing for a while, and then connect with the motor after the lubricant inside come out.



Caution

Be sure to hold the handpiece firmly to prevent the handpiece from slipping out by the spray pressure when lubricating. Supply lubricant until it comes out of the handpiece nose (for approx 2 seconds)
Keep the SPRAY can upright

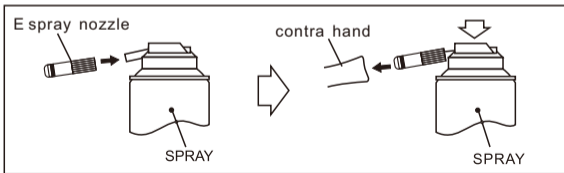
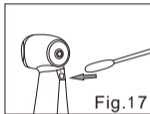


Fig. 18

Clean-head system

1-Scrub dirt and debris from the handpiece.

2-Stop the handpiece and wipe it dry.If the dirt could not remove from the hole, remove the cartridge and clean by brush.



⚠ Notice !

Use only clean water to maintain the clean head system.

Cleaning -bulb

Wipe clean the Cellular optical bulb entry point with an alcohol-immersed cotton swab.Remove all debris and oil.

Sterilization and cleaning

- Steam autoclave is recommended.
- Sterilization requirement after using as noted below.
- Autoclave Procedure:
 - Scrub dirt and debris from the handpiece, and wipe clean with alcoholic cotton. Do not use a wire brush (Fig. 18.4)
 - Lubricate with SPRAY or Lubricant oil.
 - Lubrication.
 - Insert into an autoclave pouch. Seal the pouch.
 - Autoclavable up to a max. 135°C (EX.) Autoclave for 20 min. at 121°C or 15 min. at 132°C (Fig. 18.2/18.3).

NOTE: After treatment or before autoclave, please do the lubrication.

NOTE:After treatment or before autoclave,please do the lubrication.

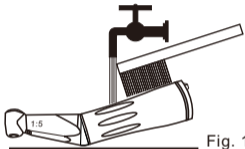


Fig. 18.4

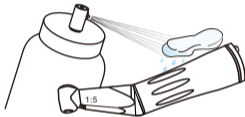


Fig. 18.5



Fig. 18.6

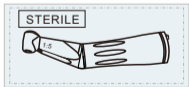


Fig. 18.7



275° F

Fig. 18.8

Trouble Shooting

Trouble	Possible cause	Solution
Body of straight head or contra angle rotates during motor running	O-ring on the nose of motor wears	Change o-ring
Handpiece fail to rotate	Contra angle chucking with bur but lath plate fail to be fixed in the proper position. dirt get into the handpiece	Clean and lubricate, move it by hand

Our service center can offer technical assistance to you.

Warranty

COXO grants the user a 12 months guarantee for its complete product range, except ball bearing (3 months guarantee) from the date of invoice issued, Maintenance over the term of guarantee will be at the customer's charge. COXO will not be responsible for damage or injury resulting from:

- excessive use
- improper manipulation of the product, or modification to product carried out by persons not authorized by COXO.
- fail to follow the instruction to install, operate and maintenance the handpiece.
- damage of chemical, electrical or electrolysis due to improper autoclaving and storing.
- improper working pressure.

The technical specifications and dimension in these instruction are given only as a guide. They may not be subject of any claim.

Standard Symbols

On the instrument label appear standard symbols as follows:



Important notice!



Autoclave



Attention, consult accompanying documents



Class II equipment



Type B applied part



Certified to MDD93/42/EEC

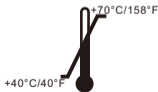


Manufacturer

Transportation and deposited condition

Environmental temperature range: -40°C — $+50^{\circ}\text{C}$; Relative humidity $\leq 80\%$;

The scope of air pressure: 500hPa—1060hPa.





COXO[®]

Foshan COXO medical instrument Co.,Ltd

Address:21 Wufeng Si Road,Foshan,Guangdong,China



Wellkang Ltd.

Address:SuiteB,29 Harely Street,London W1G9QR,United Kingdom